

**QSV10KS**

# DIESEL GENSET SPECIFICATION

10kVA (PRP) / 11kVA (ESP)

ID: 1000033682

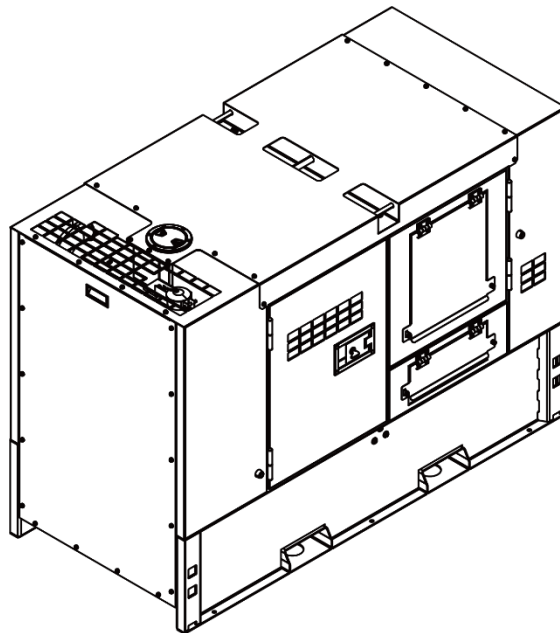

## Diesel Genset Specification

QSV10KS

### General technical data

|                               |               |                 |                      |
|-------------------------------|---------------|-----------------|----------------------|
| Model                         | QSV10KS       | Rated voltage V | Current A            |
| Structure                     | PT            | 380             | 15.2                 |
| Prime power (PRP): kVA / kW   | 10 / 8        | 400             | 14.4                 |
| Standby power (ESP): kVA / kW | 11 / 9        | 415             | 13.9                 |
| Frequency: Hz                 | 50            | 440             | 13.1                 |
| Rotate speed: RPM             | 1500          |                 |                      |
| Phase: P                      | 3             |                 |                      |
| Power factor: $\cos\phi$      | 0.8           | Load            | Fuel consumption L/h |
| Protection class              | IP54          | 25%             | N/A                  |
| Noise level: dB@7m            | 59.0          | 50%             | 1.8                  |
| Tank capacity: L              | 30            | 75%             | 2.9                  |
| Dimensions: mm                | 1550×680×1060 | 100%            | 3.5                  |
| Dry weight: kg                | 730           | 110%            | 3.9                  |

### Main Features

| Advantage  | Design Standards   | Environmental Operating Conditions   |
|--|--|--|
| <ul style="list-style-type: none"> <li>Low fuel consumption</li> <li>Optimized system</li> <li>High reliability</li> <li>High availability</li> </ul>  | <ul style="list-style-type: none"> <li>Conformite Europeenne (CE)</li> <li>ISO8528-5:2005</li> </ul> | <ul style="list-style-type: none"> <li>Installation place: outdoor / indoor (well ventilated).</li> <li>Ambient temperature: -25°C to 45°C (the coolant heater is needed when the temperature is below 5°C)</li> <li>Humidity: Less than 80%</li> <li>Altitude: Below one thousand (1000) meters.</li> </ul> |
| Factory Inspection   | Service Support  | Performance Guarantee  |
| <ul style="list-style-type: none"> <li>Protection devices working test</li> <li>Starting ability in normal temperature</li> <li>50% rated power load moment capability</li> <li>Load test :0, 25%, 50%, 75%, 100%, 110%</li> </ul> | <ul style="list-style-type: none"> <li>Global product service support</li> </ul>                     | <ul style="list-style-type: none"> <li>Product design, manufacturing and performance have been verified by standards</li> <li>Generator set has passed transient response test according to ISO8528-5</li> <li>Both engine and alternator have passed prototype factory testing.</li> </ul>                  |

## Diesel Genset Specification

QSV10KS

### Power System

#### Engine

|                        |          |                            |                   |
|------------------------|----------|----------------------------|-------------------|
| Manufacturer / brand   | Kubota   | Intake system              | Natural aspirated |
| Model                  | D1105-BG | Intake resistance: kPa     | ≤1.96             |
| Cylinders              | 3L       | Exhaust back pressure: kPa | ≤7.07             |
| Bore: mm               | 78       | Oil capacity: L            | 5.1               |
| Stroke: mm             | 79       | Coolant capacity: L        | 6.4               |
| Displacement: L        | 1.12     | Battery voltage: V         | 12                |
| Compression ratio      | 22.0     | Dimensions: mm             | 549×398×605       |
| Rotate speed: RPM      | 1500     | Dry weight: kg             | 93                |
| Prime power: kWm       | 8.4      |                            |                   |
| Standby power: kWm     | 9.5      |                            |                   |
| Rotate speed governor  | Mech     |                            |                   |
| Type of fuel Injection | Direct   |                            |                   |

#### Alternator

|                      |             |                                   |       |
|----------------------|-------------|-----------------------------------|-------|
| Manufacturer / brand | Leroysoner  | Insulation class                  | H     |
| Model                | LSA40VS1    | Temperature rising class          | H     |
| Exciter              | Brushless   | Protection class                  | IP23  |
| Windings             | 100% copper | Voltage regulation                | ±1.0% |
| Winding pitch        | 2/3         | Telephone harmonic factor THF     | <2%   |
| Number of poles      | 4           | Telephone interference factor TIF | <50   |
| Terminals            | 12          |                                   |       |

### Control System

|       |           |
|-------|-----------|
| Brand | POWERLINK |
| Model | PLC-920   |

#### General Functions

- Automatic start / stop control
- Manual/remote start control
- Real time monitoring and display of multiple parameters
- RS232, RS485 interface and Ethernet can be used simultaneously
- CAN and Modbus communication
- Provide complete control solutions

#### Monitoring and protection

|                   |                 |
|-------------------|-----------------|
| Oil pressure      | Over load       |
| Water temperature | Over current    |
| Rotate speed      | Over voltage    |
| Start             | Under voltage   |
| Running time      | Over frequency  |
| Battery voltage   | Under frequency |
| .....             | .....           |

## Product Appearance

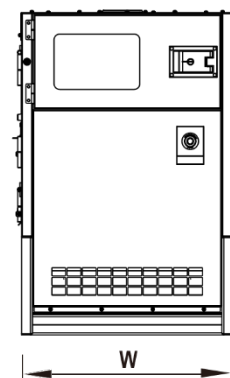
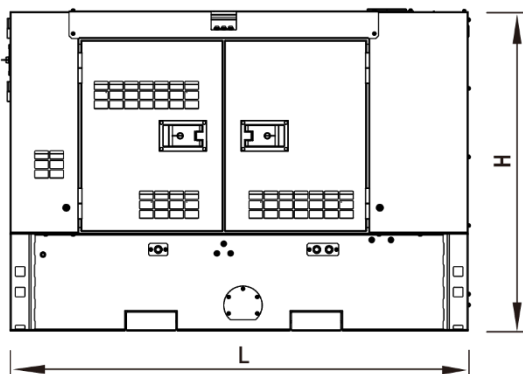
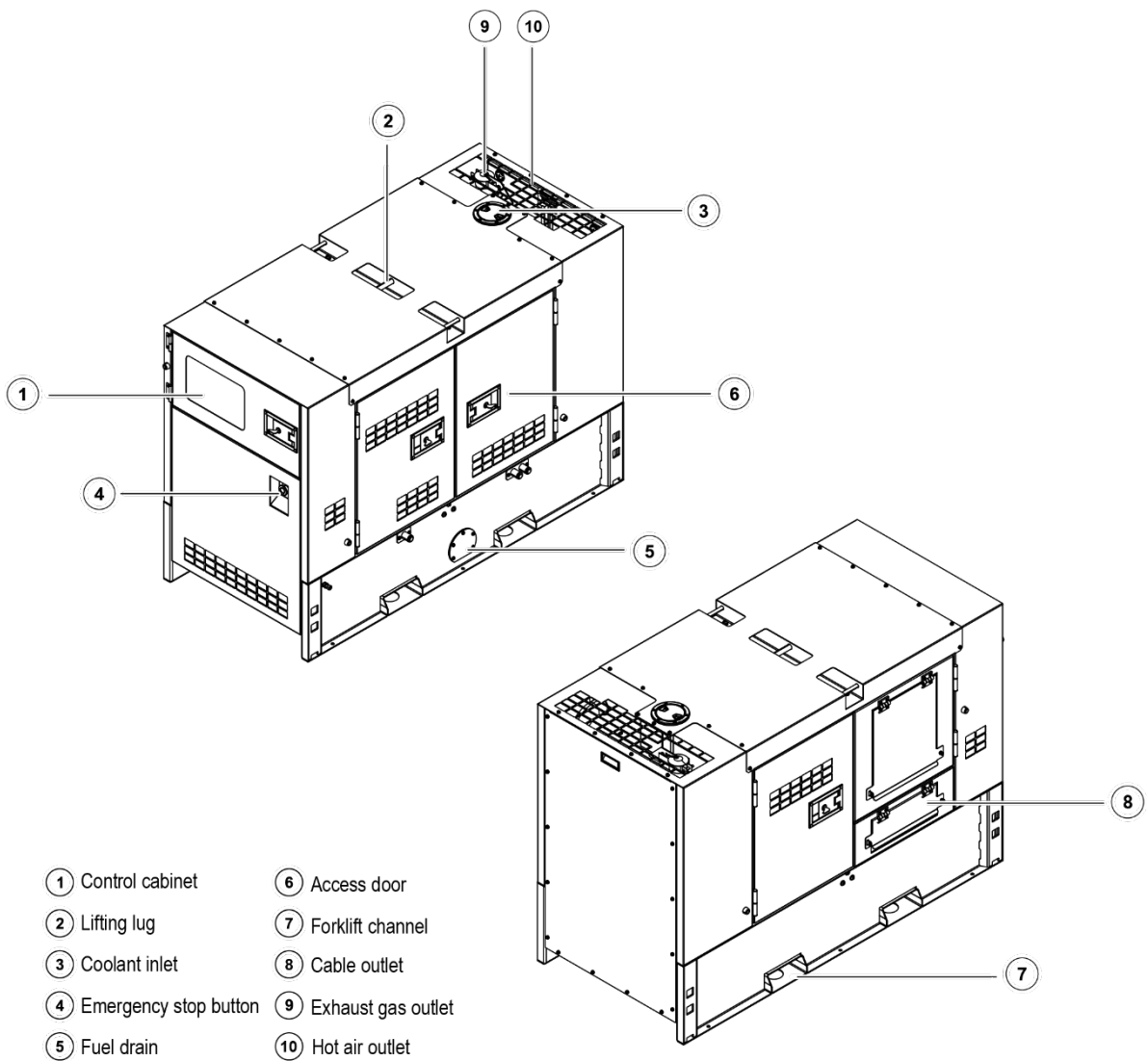

## Product Configuration

### Standard configuration

| Engine                   | Generator                  | Control switchgear      | Canopy (sound-proof)               | Base Frame                              |
|--------------------------|----------------------------|-------------------------|------------------------------------|---|
| Electrical start motor   | Alternator                 | PLC control system      | Steel plate                        | Steel base frame                        |
| Battery system           | H class insulation         | Main circuit breaker    | Corrosion-resistant coating        | Engine bracket                          |
| Speed control system     | H class temperature rising | Breaker cabinet         | Access door                        | Alternator bracket                      |
| Natural aspirated        | IP23 protection            | Communication connector | Stainless steel hinge              | Radiator bracket                        |
| Lockable isolator switch | AVR voltage regulator      | ATS connector           | Sound absorbing cotton             | Vibration isolators                     |
| Battery charger          |                            | Mains floating charger  |                                    |   |
| Fuel system              | Lubrication system         | Cooling system          | Intake / exhaust system            | Service documents                       |
| Base frame fuel tank     | Oil pressure sensor        | 50°C radiator           | Air filter                         | Installation and operation manual       |
| Fuel level sensor        | Oil temperature sensor     | Water level sensor      | Exhaust muffler                    | Test report                             |
| Flexible connection pipe | Oil filter                 | Jacket water pipe       | Exhaust bellow                     | Circuit diagram                         |
| Fuel filter              | Manual oil drain pump      | Intercooling pipe       | Exhaust pipe and flange            | Warranty manual                         |
|                          | Oil drain ball valve       |                         | High temperature protective sleeve | Engine operation and maintenance manual |
|                          |                            |                         |                                    | Standard package                        |

### Optional configuration

| Engine                 | Alternator                                | Control switchgear         | Fuel system          | Lubrication system      |
|------------------------|---|----------------------------|----------------------|-------------------------|
| Jacket water preheater | Anti-condensation heater                  | 4P circuit breaker         | Fuel three-way valve | Electric oil drain pump |
| Oil preheater          | Treatments against humidity and corrosion | ATS cabinet                | Daily fuel tank      |                         |
|                        |   | Paralleling control system |                      |                         |
|                        |   | Grid-connection system     |                      |                         |

### Power Class Definition

- Prime Power (PRP): the unit runs continuously with variable load, the number of operating hours is not limited, and 1h overload 10% operation is allowed per 12h, and the average load factor is less than 70% per 24h.
- Standby Power (ESP): operating time does not exceed 500h per year, continuous operating time does not exceed 300h, the average load factor is less than 80% per 24h. Overload operation is not allowed.

### Product Statement

- The data of specifications is based on the following standard environmental test conditions.
  - Ambient temperature 25°C
  - Altitude 100m
  - Relative humidity 30%
- Dimensions, weight and other parameters are for reference only, which shall be subject to the final design drawing.



www.powerlinkenergy.com

Data is subject to change without prior notice as new products are always developed.

Please contact PowerLink or local agent with any doubts or for more information.